

INSTRUCTIONS

Tower Stand

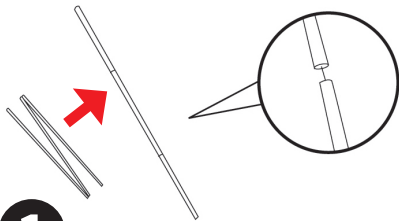

Includes:
Sectional Tube Frame
Base
Top Arm
Black Canvas Bag



1

Unfold and align sectional tube frame.

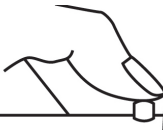

2

To connect the sectional pieces together, press the button and slide pieces together until buttons snap in place.

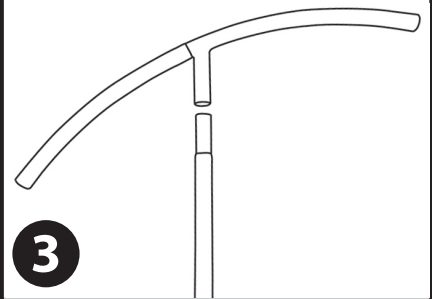

3

Attach the top arm to the sectional pieces you just assembled.

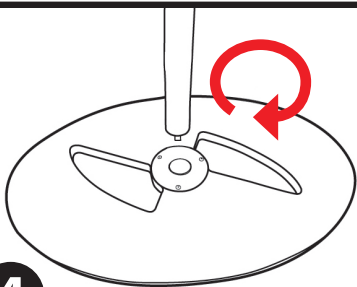

4

Align assembled parts over the base and screw clockwise.

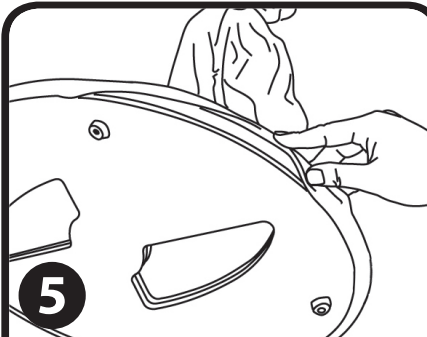

5

Pull the fabric banner over the frame and over the lip of the base.

